

HIGHLIGHTS OF PRESCRIBING INFORMATION

These highlights do not include all the information needed to use XEMBIFY safely and effectively. See full prescribing information for XEMBIFY.

XEMBIFY (immune globulin subcutaneous, human – klhw) 20% solution
Initial U.S. Approval: 2019

WARNING: THROMBOSIS

See full prescribing information for complete boxed warning.

- Thrombosis may occur with immune globulin products, including XEMBIFY. Risk factors may include: advanced age, prolonged immobilization, hypercoagulable conditions, history of venous or arterial thrombosis, use of estrogens, indwelling vascular catheters, hyperviscosity, and cardiovascular risk factors. Thrombosis may occur in the absence of known risk factors.
- For patients at risk of thrombosis, administer XEMBIFY at the minimum dose and infusion rate practicable. Ensure adequate hydration in patients before administration. Monitor for signs and symptoms of thrombosis and assess blood viscosity in patients at risk for hyperviscosity.

RECENT MAJOR CHANGES

Dosage and Administration, Dose (2.1) 7/2024

Dosage and Administration, Administration (2.3) 7/2024

INDICATIONS AND USAGE

XEMBIFY® (immune globulin subcutaneous, human-klhw) is a 20% immune globulin solution for subcutaneous injection indicated for treatment of Primary Humoral Immunodeficiency (PI) in patients 2 years of age and older. (1)

DOSAGE AND ADMINISTRATION

For subcutaneous infusion only

Dose (2.1)

XEMBIFY can be administered at regular intervals from daily up to every two weeks (biweekly).

- **Switching to XEMBIFY from intravenous immune globulin (IVIG):** If a patient is switching to XEMBIFY, obtain the patient's serum IgG trough level to guide subsequent dose adjustments. Establish the initial weekly dose in grams by converting the monthly (or every 3 weeks) IVIG dose into an equivalent weekly dose and increasing it by using a dose adjustment factor (1.37)
$$\text{Initial weekly dose (grams)} = \frac{\text{Prior IVIG dose (in grams)} \times 1.37}{\text{Number of weeks between IVIG doses}}$$
 - **Weekly:** Begin XEMBIFY one week after last IVIG infusion.
 - **Frequent dosing (2-7 times per week):** Divide the calculated weekly dose by the desired number of times per week.
 - **Biweekly dosing (every 2 weeks):** Multiply the weekly dose by 2.
- **Switching to XEMBIFY from subcutaneous immune globulin (IGSC):** Administer the same weekly dose (grams) as the weekly dose of prior IGSC treatment (grams).
- **Treatment-naïve patients:** For patients starting IgG replacement (not switching from IVIG or IGSC) administer loading doses of 150 mg/kg/day for 5 consecutive days, followed by weekly administrations starting at Day 8 at 150 mg/kg/week. Monitor IgG trough levels frequently every 2 weeks during first 8 weeks.

Administration (2.3)

Infusion sites: up to 6 infusion sites simultaneously, with at least 2 inches (5 cm) between sites avoiding bony prominences, visible blood vessels, scars,

and any areas of inflammation (irritation) or infection. Rotate sites for each administration.

Patient Age	Maximum Volume (mL/infusion site)	Infusion Rate (mL/hr/infusion site)
Children 2 to <10 years	25	≤25
Adults, children ≥10 years	25	≤35

DOSAGE FORMS AND STRENGTHS

XEMBIFY is a solution containing 0.2 g/mL (200 mg/mL; 20%) protein solution for subcutaneous infusion. (3)

CONTRAINDICATIONS

- Anaphylactic or severe systemic reactions to human immunoglobulin or inactive ingredients of XEMBIFY such as polysorbate 80. (4)
- IgA deficient patients with antibodies against IgA and a history of hypersensitivity. (4)

WARNINGS AND PRECAUTIONS

- Aseptic Meningitis Syndrome (AMS) occurs within two days of treatment. (5.1)
- Hypersensitivity and anaphylactic reactions may occur. IgA deficient patients with antibodies against IgA are at greater risk of developing severe hypersensitivity or anaphylactic reactions. (5.3)
- Monitor for renal function in patients at risk for renal failure. (5.4)
- Hemolysis can develop. Risk factors include high doses and non-O blood group. Closely monitor for hemolysis and hemolytic anemia. (5.5)
- Monitor patients for pulmonary adverse reactions (transfusion-related acute lung injury [TRALI]). (5.6)
- XEMBIFY is made from human plasma and may carry a risk of transmitting infectious agents, e.g., viruses, the variant Creutzfeldt-Jakob disease (vCJD) agent and, theoretically, the Creutzfeldt-Jakob disease (CJD) agent. (5.7)
- Passive transfer of antibodies may confound serologic testing. (5.8)

ADVERSE REACTIONS

The most common adverse reactions in ≥ 5% of patients in the clinical trial were local adverse reactions including infusion site erythema (redness), infusion site pain, infusion site swelling (puffiness), infusion site bruising, infusion site nodule, infusion site pruritus (itching), infusion site induration (firmness), infusion site scab, infusion site edema, and systemic reactions including cough and diarrhea. (6.1)

To report SUSPECTED ADVERSE REACTIONS, contact Grifols Therapeutics LLC at 1-800-520-2807 or FDA at 1-800-FDA-1088 or www.fda.gov/medwatch.

DRUG INTERACTIONS

The passive transfer of antibodies may transiently interfere with the response to live virus vaccines, such as measles, mumps, rubella, and varicella. (7.2)

USE IN SPECIFIC POPULATIONS

Geriatric: In patients over 65 years, do not exceed the recommended dose and infuse XEMBIFY at the minimum rate practicable. (8.5)

See 17 for PATIENT COUNSELING INFORMATION and FDA-approved patient labeling.

Revised: M/YYYY

FULL PRESCRIBING INFORMATION: CONTENTS*

WARNING: THROMBOSIS

1 INDICATIONS AND USAGE

2 DOSAGE AND ADMINISTRATION

2.1 Dose

2.2 Preparation and Handling

2.3 Administration

3 DOSAGE FORMS AND STRENGTHS

4 CONTRAINDICATIONS

5 WARNINGS AND PRECAUTIONS

5.1 Aseptic Meningitis Syndrome

5.2 Thrombosis

5.3 Hypersensitivity

5.4 Renal Dysfunction/Failure

5.5 Hemolysis

5.6 Transfusion-Related Acute Lung Injury

5.7 Transmissible Infectious Agents

5.8 Interference with Laboratory Tests

6 ADVERSE REACTIONS

6.1 Clinical Trials Experience

6.2 Postmarketing Experience

7 DRUG INTERACTIONS

7.1 Serological Testing

7.2 Live Attenuated Virus Vaccines

8 USE IN SPECIFIC POPULATIONS

- 8.1 Pregnancy
- 8.2 Lactation
- 8.4 Pediatric Use
- 8.5 Geriatric Use

11 DESCRIPTION

12 CLINICAL PHARMACOLOGY

- 12.1 Mechanism of Action
- 12.2 Pharmacodynamics

12.3 Pharmacokinetics

13 NONCLINICAL TOXICOLOGY

- 13.1 Carcinogenesis, Mutagenesis, Impairment of Fertility
- 13.2 Animal Toxicology and/or Pharmacology

14 CLINICAL STUDIES

15 REFERENCES

16 HOW SUPPLIED/STORAGE AND HANDLING

17 PATIENT COUNSELING INFORMATION

* Sections or subsections omitted from the full prescribing information are not listed.

FULL PRESCRIBING INFORMATION

WARNING: THROMBOSIS

- **Thrombosis may occur with immune globulin products, including XEMBIFY. Risk factors may include: advanced age, prolonged immobilization, hypercoagulable conditions, history of venous or arterial thrombosis, use of estrogens, indwelling central vascular catheters, hyperviscosity, and cardiovascular risk factors. Thrombosis may occur in the absence of known risk factors. [see *Warnings and Precautions (5.2)*, *Patient Counseling Information (17)*]**
- **For patients at risk of thrombosis, administer XEMBIFY at the minimum dose and infusion rate practicable. Ensure adequate hydration in patients before administration. Monitor for signs and symptoms of thrombosis and assess blood viscosity in patients at risk for hyperviscosity. [see *Warnings and Precautions (5.2)*]**

1 INDICATIONS AND USAGE

XEMBIFY® (immune globulin subcutaneous, human-klhw) is a 20% immune globulin solution for subcutaneous injection indicated for treatment of primary humoral immunodeficiency (PI) in patients 2 years of age and older. This includes, but is not limited to, congenital agammaglobulinemia, common variable immunodeficiency, X-linked agammaglobulinemia, Wiskott-Aldrich syndrome, and severe combined immunodeficiencies.¹⁻⁴

2 DOSAGE AND ADMINISTRATION

For subcutaneous infusion only

2.1 Dose

XEMBIFY can be administered at regular intervals from daily up to every two weeks (biweekly).

Doses divided over the course of a week, once weekly, or biweekly achieve similar exposure when administered regularly at steady-state.

Individualize the dose based on the patient's pharmacokinetic and clinical response.

Monitor serum IgG trough levels regularly to guide subsequent dose adjustments and dosing intervals as needed (see *Dose adjustments*).

If a patient is switching to XEMBIFY, obtain the patient's serum IgG trough level to guide subsequent dose adjustments.

Switching to XEMBIFY from intravenous immune globulin (IVIG)

Begin treatment with XEMBIFY one week after the patient's last IVIG infusion.

Calculate the initial weekly dose of XEMBIFY. Divide the previous monthly (or every 3 weeks) IVIG dose in grams by the number of weeks between IVIG infusions, then multiply this dose by the dose adjustment factor of 1.37.

$$\text{Initial weekly dose (grams)} = \frac{\text{Prior IVIG (in grams)}}{\text{Number of weeks between IVIG doses}} \times 1.37$$

To convert the XEMBIFY dose (in grams) to milliliters (mL), multiply the calculated Initial SC dose (in grams) by 5.

To determine the dose for alternative regular dosing intervals:

- Frequent dosing (2-7 times per week): Divide the calculated weekly dose by the desired number of times per week.
- Biweekly dosing: Multiply the calculated weekly dose by 2.

To guide dose adjustments, see section *Dose adjustments* (Table 2).

Switching to XEMBIFY from subcutaneous immune globulin (IGSC)

Administer the same weekly dose of XEMBIFY (in grams) as the weekly dose of prior IGSC treatment (in grams).

To convert the XEMBIFY dose (in grams) to milliliters (mL), multiply the calculated Initial SC dose (in grams) by 5.

To determine the dose for alternative regular dosing intervals:

- Frequent dosing (2-7 times per week): Divide the calculated weekly dose by the desired number of times per week.
- Biweekly dosing: Multiply the calculated weekly dose by 2.

To guide dose adjustments, see section *Dose adjustments* (Table 2).

Treatment-naïve patients

The recommended dosage for treatment naïve patients with Primary Immunodeficiency is shown in Table 1.

Table 1: Dosing Regimen for Treatment-naïve Patients with Primary Immunodeficiency

Loading Dose	Maintenance Dose	IgG Trough Monitoring
150 mg/kg/day for 5 consecutive days	150 mg/kg/week - weekly administrations starts at Day 8	Monitor IgG trough levels every 2 weeks for the first 8 weeks of XEMBIFY dosing

To guide dose adjustments, see section *Dose adjustments* (Table 2).

Dose adjustments

For dose adjustments, calculate the difference (in mg/dL) of the patient’s serum IgG trough level from the target IgG trough level, then find this difference in Table 2 (below). Locate the corresponding amount (in mL) by which to increase or decrease the weekly dose based on the patient’s body weight. For example, if a patient with a body weight of 70 kg has an actual IgG trough level of 900 mg/dL and the target level is 1,000 mg/dL, this results in a difference of 100 mg/dL. Therefore, increase the weekly dose of subcutaneous dose by 5 mL.

The patient’s clinical response should be the primary consideration in dose adjustment. If a patient on XEMBIFY does not maintain an adequate clinical response or a serum IgG trough level equivalent to that of a previous treatment, adjust the dose accordingly.

Table 2: Adjustment (±mL) of the Weekly Subcutaneous Dose Based on the Difference (±mg/dL) From the Target Serum IgG Trough Level

Difference From Target IgG Trough Level (mg/dL)	Body Weight (kg)												
	10	15	20	30	40	50	60	70	80	90	100	110	120
	Dose Adjustment (mL per Week)*												
50	0	1	1	1	2	2	2	3	3	3	4	4	5
100	1	1	2	2	3	4	5	5	6	7	8	8	9
150	1	2	2	3	5	6	7	8	9	10	11	13	14
200	2	2	3	5	6	8	9	11	12	14	15	17	18
250	2	3	4	6	8	9	11	13	15	17	19	21	23
300	2	3	5	7	9	11	14	16	18	20	23	25	27
350	3	4	5	8	11	13	16	19	21	24	27	29	32
400	3	5	6	9	12	15	18	21	24	27	30	33	36
450	3	5	7	10	14	17	20	24	27	31	34	38	41
500	4	6	8	11	15	19	23	27	30	34	38	42	45

* Dose adjustment in mL is based on the slope of the serum IgG trough level response to subcutaneous administration of XEMBIFY dose increments (about 6.6 mg/dL per increment of 1 mg/kg per week).

2.2 Preparation and Handling

XEMBIFY is a clear to slightly opalescent, and colorless or pale yellow solution.

Visually inspect XEMBIFY for particulate matter and discoloration prior to administration, whenever solution and container permit.

Do not use if the solution is cloudy or turbid.

Do not shake.

Do not dilute.

The XEMBIFY vial is for single use only.

Do not store any vial that has been entered by a needle during preparation for infusion, punctured, partially used, or opened.

Administer within 8 hours after beginning infusion preparation (i.e., once XEMBIFY is transferred from the vial into a syringe).

Administer XEMBIFY separately from other drugs or medications that the patient may be receiving.

Do not mix XEMBIFY with other medications including immune globulins from other manufacturers.

Do not use after expiration date.

Discard unused portion.

2.3 Administration

Prior to use, allow the solution to reach ambient room temperature.

Do not shake.

Follow the steps below and use aseptic technique to administer XEMBIFY.

1. Inspect the vials: inspect for clarity, color, and expiration date (s).
2. Prepare for infusion:

Gather supplies: XEMBIFY vial(s), ancillary supplies, sharps container, patient's treatment diary/logbook, and the infusion pump.

Prepare a clean work area.

Wash hands.

3. Remove the protective cap from the vial to expose the central portion of the stopper.

If the packaging shows any sign of tampering, do not use the product and notify Grifols Therapeutics LLC immediately [1-800-520-2807].

4. Wipe the stopper with alcohol and allow to dry.

5. Using a sterile syringe and needle, prepare to withdraw XEMBIFY by first injecting air into the vial that is equivalent to the amount of XEMBIFY to be withdrawn. Then withdraw the desired volume of XEMBIFY. If multiple vials are required to achieve the desired dose, repeat this step. (Figure 1)



Figure 1

6. Use XEMBIFY as soon as practicable, within 2 hours to avoid the potential formation of particles caused by siliconized syringes.
7. Follow the manufacturer's instructions for preparing the pump and administration tubing. Be sure to prime the administration tubing to ensure that no air is left in the tubing or needle by filling the tubing/needle with XEMBIFY.

8. Select the number and location of injection sites. Rotate sites for each administration. (Figure 2)

Infuse XEMBIFY in the abdomen, thigh, upper arm, sides, back and/or lateral hip.

Avoid bony areas, scars, areas of inflammation, superficial infection or blood vessels.

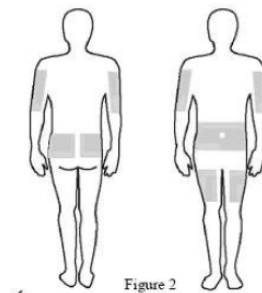

Figure 2

9. Cleanse the injection site(s) with antiseptic solution using a circular motion working from the center of the site and moving to the outside. Sites should be clean, dry, and at least 2 inches (5 cm) apart. (Figure 3)

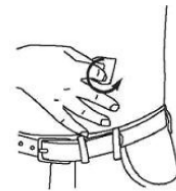

Figure 3

- Grasp the skin between 2 fingers (pinch at least one inch (2.5cm) of skin) and insert the needle at a 90-degree angle into the subcutaneous tissue. (Figure 4)



Figure 4

- After inserting each needle, make sure that a blood vessel has not been accidentally entered. Attach a sterile syringe to the end of the primed administration tubing, pull back on the plunger, and if you see blood, remove and discard the needle and administration tubing. (Figure 5)



Figure 5

- Repeat priming and needle insertion steps using a new needle, administration tubing and a new infusion site. Secure the needle in place by applying sterile gauze or transparent dressing over the site.
- Infuse XEMBIFY at a maximum rate as per [Table 3](#) using up to 6 infusion sites. Ensure that the infusion sites are at least 2 inches (5 cm) apart for patients of all ages. The number of infusion sites is at healthcare provider discretion. Children will require less total volume for a specific XEMBIFY dose (mg/kg body weight) than adults. The healthcare provider may choose a smaller volume/site for children and/or fewer infusion sites to achieve the target total dose, depending on the needs of the child. The total dose volume of XEMBIFY is divided by the desired volume (mL/site) to obtain number of infusion sites to be used.

Table 3: Infusion Parameters for Children and Adults with PI

Patient Age	Maximum Volume to Be Infused SC	Rate	Number of Infusion Sites	Site Distance Apart
Children 2 to <10 years of age	25 mL per site	≤25 mL/hr/infusion site	≤6	≥2 inches (5 cm)
Adults and children 10 years and older	25 mL per site	≤35 mL/hr/infusion site	≤6	≥2 inches (5 cm)

Record information about the infusion (e.g., lot number, expiration date, dose, date, time, infusion site location(s), side effects) in a patient treatment record or infusion log.

- Discard the needle(s) and infusion line(s) in an appropriate container. Follow the manufacturer's instructions for storage of the infusion pump.
- Discard partially used vial(s).

3 DOSAGE FORMS AND STRENGTHS

XEMBIFY is a protein solution containing 20% IgG (200 mg/mL; 0.2 g/mL) for subcutaneous infusion.

4 CONTRAINDICATIONS

XEMBIFY is contraindicated in:

Patients who have had an anaphylactic or severe systemic reaction to the administration of human immune globulin.

IgA deficient patients with antibodies against IgA and history of hypersensitivity to human immune globulin treatment.

5 WARNINGS AND PRECAUTIONS

5.1 Aseptic Meningitis Syndrome

Aseptic meningitis syndrome (AMS) has been reported with the use of human immune globulin administered intravenously and subcutaneously, including XEMBIFY. AMS usually begins within several hours to 2 days following immune globulin treatment. AMS may occur more frequently in females than in males.

AMS is characterized by the following signs and symptoms: severe headache, nuchal rigidity, drowsiness, fever, photophobia, painful eye movements, nausea and vomiting. Cerebrospinal fluid (CSF) studies frequently show pleocytosis up to several thousand cells per cubic millimeter, predominantly from the granulocytic series, and elevated protein levels up to several hundred mg/dL, but negative culture results. To rule out other causes of meningitis, conduct a thorough neurological examination on patients exhibiting such symptoms and signs, including CSF studies. AMS may occur more frequently in association with high doses (≥ 2 g/kg) and/or rapid infusion of immune globulin products. Discontinuation of immune globulin treatment has resulted in remission of AMS within several days without sequelae.

5.2 Thrombosis

Thrombosis may occur following treatment with immune globulin products, including XEMBIFY.⁵⁻⁷ Risk factors may include advanced age, prolonged immobilization, hypercoagulable conditions, history of venous or arterial thrombosis, use of estrogens, indwelling central vascular catheters, hyperviscosity, and cardiovascular risk factors. Thrombosis may occur in the absence of known risk factors.

Consider baseline assessment of blood viscosity in patients at risk for hyperviscosity, including those with cryoglobulins, fasting chylomicronemia/markedly high triacylglycerols (triglycerides), or monoclonal gammopathies. For patients at risk of thrombosis, administer XEMBIFY at the minimum dose and infusion rate practicable. Ensure adequate hydration in

patients before administration. Monitor for signs and symptoms of thrombosis and assess blood viscosity in patients at risk for hyperviscosity. [see *Boxed Warning, Dosage and Administration (2.3), Patient Counseling Information (17)*]

5.3 Hypersensitivity

Severe hypersensitivity reactions may occur with human immune globulin products, including XEMBIFY. If a hypersensitivity reaction occurs, discontinue the XEMBIFY infusion immediately and institute appropriate treatment.

XEMBIFY contains IgA. Patients with known anti-IgA antibodies have a greater risk of developing potentially severe hypersensitivity reactions, including anaphylaxis. XEMBIFY is contraindicated in IgA deficient patients with antibodies against IgA and history of hypersensitivity to human immune globulin treatment. [see *Contraindications (4)*]

5.4 Renal Dysfunction/Failure

Acute renal dysfunction/failure, acute tubular necrosis, proximal tubular nephropathy, osmotic nephrosis and death may occur upon use of human immune globulin products, especially those containing sucrose.^{8,9} XEMBIFY does not contain sucrose. Ensure that patients are not volume depleted prior to administration of XEMBIFY.

In patients with any degree of preexisting renal insufficiency or predisposition to acute renal failure (such as diabetes mellitus, age greater than 65 years, volume depletion, sepsis, paraproteinemia, or patients receiving known nephrotoxic drugs), monitor renal function and consider lower, more frequent dosing. [see *Dosage and Administration (2.3)*]

Periodic monitoring of renal function and urine output is particularly important in patients judged to have a potential increased risk for developing acute renal failure. Assess renal function, including measurement of blood urea nitrogen (BUN)/serum creatinine, prior to the initial infusion of XEMBIFY and again at appropriate intervals thereafter. If renal function deteriorates, consider discontinuation of XEMBIFY. [see *Patient Counseling Information (17)*]

5.5 Hemolysis

IgG products, including XEMBIFY can contain blood group antibodies that may act as hemolysins and induce *in vivo* coating of red blood cells (RBCs) with immunoglobulin, causing a positive direct antiglobulin (Coombs') test result and hemolysis.¹⁰⁻¹³ Delayed hemolytic anemia can develop subsequent to human immune globulin therapy due to enhanced RBC sequestration, and acute hemolysis consistent with intravascular hemolysis has been reported. [see *Adverse Reactions (6)*]

Monitor XEMBIFY recipients for clinical signs and symptoms of hemolysis, particularly patients with risk factors such as non-O blood group, or patients receiving high IgG doses (≥ 2 grams/kg).¹⁴ Underlying inflammatory state in an individual patient may increase the risk of hemolysis, but its role is uncertain.¹⁵

If signs and/or symptoms of hemolysis are present after XEMBIFY infusion, perform appropriate confirmatory laboratory testing.

5.6 Transfusion-related Acute Lung Injury

Noncardiogenic pulmonary edema (transfusion-related acute lung injury [TRALI]) may occur in patients following treatment with human immune globulin products.¹⁶ TRALI is characterized by severe respiratory distress, pulmonary edema, hypoxemia, normal left ventricular function, and fever. Symptoms typically occur within 1 to 6 hours after treatment.

Monitor patients for pulmonary adverse reactions. If TRALI is suspected, perform appropriate tests for the presence of anti-neutrophil and anti-HLA antibodies in both the product and patient serum. TRALI may be managed using oxygen therapy with adequate ventilatory support.

5.7 Transmissible Infectious Agents

Because XEMBIFY is made from human blood, it may carry a risk of transmitting infectious agents, e.g., viruses, the variant Creutzfeldt-Jakob disease (vCJD) agent and, theoretically, the Creutzfeldt-Jakob disease (CJD) agent. This also applies to unknown or emerging viruses and other pathogens. No cases of transmission of viral diseases or CJD have been associated with the use of XEMBIFY. ALL infections suspected by a physician to have possibly been transmitted by XEMBIFY should be reported by the physician or other healthcare provider to Grifols Therapeutics LLC [1-800-520-2807].

5.8 Interference with Laboratory Tests

After infusion with XEMBIFY, the transitory rise of various passively transferred antibodies in the patient's blood may yield false-positive serological testing results, with the potential for misleading interpretation. Passive transmission of antibodies to erythrocyte antigens (e.g., A, B, and D) may cause a positive direct or indirect antiglobulin (Coombs') test.

6 ADVERSE REACTIONS

6.1 Clinical Trials Experience

Because clinical studies are conducted under widely varying conditions, adverse reaction rates observed in the clinical trials of one drug cannot be directly compared to rates in other clinical trials of another drug and may not reflect the rates observed in clinical practice.

Study 1

The safety of XEMBIFY was evaluated in an open-label, single-arm prospective multi-center study in North America in patients with PI who received subcutaneous XEMBIFY for at least 6 months [see *Clinical Studies (14)*].

A total of 49 patients (including 14 patients between 2 to 16 years of age) received 1053 XEMBIFY infusions during the clinical trial. The average number of infusions per patient was 21.5 infusions, median 24 infusions (range 1-26 infusions).

A total of 390 local infusion site reactions occurred at a rate per infusion of 0.370 (approximately 1 in 2.7 infusions). Of these, the most common was infusion site erythema which had a median duration of 24.9 hours. Infusion site swelling, and infusion site pain had median durations of 24.5 and 22.8 hours, respectively. Local infusion site reactions of all kinds by site of infusion (where site of infusion was recorded) occurred in 50.0% and 52.6% of patients during infusions in the abdomen versus thigh, respectively, and across 773 abdominal infusions and 279 thigh infusions rates were 0.184 and 0.735 per infusion, respectively; this corresponds to 1 in 5.4 infusions (for abdomen) and 1 in 1.4 infusions (for thigh). No local infusion site reactions were considered severe or serious.

The adverse reactions occurring in $\geq 5\%$ of patients on XEMBIFY in the clinical trial for the duration of the subcutaneous (SC) phase are shown in Table 4 below which includes all treatment-emergent adverse reactions except infections.

Table 4: Adverse Reactions in $\geq 5\%$ of Patients During Treatment* with XEMBIFY in Study 1

Adverse Reaction**	By Patient n (%)[†] (N=49 patients)	By Infusion n (rate)[‡] (N=1053 infusions)
Infusion site erythema	19 (39%)	123 (<1)
Infusion site pain	9 (18%)	32 (<1)
Infusion site swelling	8 (16%)	124 (<1)
Infusion site bruising	8 (16%)	26 (<1)
Infusion site nodule	8 (16%)	13 (<1)
Infusion site pruritus	5 (10%)	28 (<1)
Infusion site induration	4 (8%)	6 (<1)
Infusion site scab	3 (6%)	6 (<1)
Infusion site edema	3 (6%)	5 (<1)
Cough	3 (6%)	4 (<1)
Diarrhea	3 (6%)	3 (<1)

* The term ‘treatment’ refers to the duration of the subcutaneous phase of XEMBIFY administration.

** Including all adverse reactions that occurred after the first dose of XEMBIFY regardless of causality, excluding infections.

† Number and percentage of patients with the adverse reaction.

‡ Rate per infusion is calculated as the total number of adverse reactions divided by the total number of infusions.

Four patients discontinued XEMBIFY due to adverse reactions which were infusion site nodules, infusion site discomfort, skin papules/plaques, and arthralgia/myalgia.

Study 2

The safety of XEMBIFY during 12 months of treatment was evaluated in 61 patients (including 29 pediatric patients aged 2 to ≤16 years) in a clinical trial in Europe [see Clinical Studies (14)]. Adverse reactions in pediatric and adult patients were similar to those observed in Study 1. Among early withdrawals from the study, one patient discontinued XEMBIFY due to a related infusion site fibroma that resolved.

Study 3

The safety of XEMBIFY was compared between weekly and biweekly dosing during a single-sequence weekly-to-biweekly crossover study of 27 treatment-experienced adult patients with PI [see *Clinical Studies (14)*]. The incidence of adverse reactions was similar between dosing regimens and similar to those observed in Study 1.

The safety of XEMBIFY administered to 6 treatment-naïve adults with PI was assessed during a loading dose phase of 5 daily treatments with XEMBIFY followed by a weekly maintenance phase [see *Clinical Studies (14)*]. Adverse reactions occurring in more than one patient included infusion site swelling in 2 (33%) patients during or after 13 infusions and infusion site bruising in 2 (33%) patients during or after 2 infusions.

6.2 Postmarketing Experience

The following adverse events have been identified during post approval use of XEMBIFY. Because these events are reported voluntarily and from a population of uncertain size, it is not always possible to reliably estimate the frequency of these events or establish a causal relationship to product exposure.

Immune system disorders: Anaphylactic reaction and hypersensitivity

Nervous system disorders: Aseptic meningitis, dizziness, and paresthesia

Cardiovascular disorders: Tachycardia and hypotension

Respiratory, thoracic and mediastinal disorders: Dyspnea and chest discomfort

General disorders and administration site conditions: Injection site reactions (such as induration and warmth), chills, fatigue, and pain

The following adverse events have been identified and reported during the postmarketing use of immune globulin products administered subcutaneously:

Nervous system disorders: Tremor

Respiratory, thoracic and mediastinal disorders: Laryngospasm

7 DRUG INTERACTIONS

7.1 Serological Testing

Various passively transferred antibodies in immunoglobulin preparations, including XEMBIFY, can confound the results of serological testing.

7.2 Live Attenuated Virus Vaccines

Passive transfer of antibodies may transiently interfere with the immune response to live virus vaccines such as measles, mumps, rubella and varicella. Inform the immunizing healthcare provider of recent therapy with XEMBIFY so that appropriate measures may be taken.

8 USE IN SPECIFIC POPULATIONS

8.1 Pregnancy

Risk Summary

No human data are available to indicate the presence or absence of drug associated risk. Animal reproduction studies have not been conducted with XEMBIFY. It is not known whether XEMBIFY can cause fetal harm when administered to a pregnant woman or can affect reproduction capacity. Immune globulins cross the placenta from maternal circulation increasingly after 30 weeks of gestation. XEMBIFY should be given to a pregnant woman only if clearly indicated. In the U.S. general population, the estimated background risk of major birth defect and miscarriage in clinically recognized pregnancies is 2-4% and 15-20%, respectively.

8.2 Lactation

Risk Summary

No human data are available to indicate the presence or absence of drug associated risk. The developmental and health benefits of breastfeeding should be considered along with the mother's clinical need for XEMBIFY and any potential adverse effects on the breastfed infant from XEMBIFY or from the underlying maternal condition.

8.4 Pediatric Use

XEMBIFY was evaluated in 14 pediatric patients (2-16 years of age) with PI in a multi-center clinical trial (Study 1) and in 29 pediatric patients in Study 2 [see *Clinical Studies (14)*]. The safety and efficacy profiles were similar to adult patients. No pediatric-specific dose requirements were necessary to achieve the desired serum IgG levels.

The safety and effectiveness of XEMBIFY in pediatric patients below 2 years of age have not been established.

8.5 Geriatric Use

Clinical studies of XEMBIFY did not include sufficient numbers of patients over age 65 years to determine whether they respond differently from younger patients. In general, dose selection for an elderly patient should be cautious, usually starting at the low end of the dosing range, reflecting the greater frequency of decreased hepatic, renal, or cardiac function, and of concomitant disease or other drug therapy.

11 DESCRIPTION

XEMBIFY, immune globulin subcutaneous, human-klhw, is a 20% ready-to-use sterile, non-pyrogenic solution of human immune globulin protein for subcutaneous administration. The purity is $\geq 98\%$ IgG with a sub-class distribution similar to that found in normal serum.

XEMBIFY consists of 18% to 22% protein in 0.16 M to 0.26 M glycine and 10 to 40 mcg/mL polysorbate 80 at a pH of 4.1 to 4.8. The solution is clear to slightly opalescent, and colorless or pale yellow. The osmolality range is 280 to 404 mOsmol/kg. XEMBIFY contains no preservative and is not made with natural rubber latex.

XEMBIFY is made from large pools of human plasma by a combination of cold ethanol fractionation, caprylate precipitation and filtration, and anion-exchange chromatography. Isotonicity is achieved by the addition of glycine. XEMBIFY is incubated in the final container (at the low pH of 4.1 to 4.8).

The capacity of the manufacturing process to remove and/or inactivate enveloped and non-enveloped viruses has been validated by laboratory spiking studies on a scaled down process model, using the following enveloped and non-enveloped viruses: human immunodeficiency virus, type I (HIV-1) as the relevant virus for HIV-1 and HIV-2; bovine viral diarrhea virus (BVDV) as a model for hepatitis C virus; pseudorabies virus (PRV) as a model for large enveloped DNA viruses (e.g. herpes viruses); West Nile Virus (WNV) as a relevant virus; Reovirus type 3 (Reo) as a model for non-enveloped viruses and for its resistance to physical and chemical inactivation; hepatitis A virus (HAV) as relevant non-enveloped virus, and porcine parvovirus (PPV) as a model for human parvovirus B19.

Overall virus clearance capacity was calculated only from steps that were mechanistically independent from each other and truly additive. In addition, each step was verified to provide robust virus reduction across the production range for key parameters.

Table 5: Summary of Virus Clearance Capacity (Log₁₀)

Process Step	Enveloped Virus				Non-Enveloped Virus		
	HIV-1	BVDV	PRV	WNV	Reo3	HAV	PPV
Caprylate Precipitation/Depth Filtration	C/I*	2.7	C/I*	C/I*	≥ 3.5	≥ 3.6	4.0
Caprylate Incubation [†]	≥ 4.5	≥ 4.5	≥ 4.6	≥ 5.1	NA [‡]	NA [‡]	NA [‡]
Column Chromatography	≥ 3.0	4.0	≥ 3.3	ND [§]	≥ 4.0	≥ 1.4	4.2
Nanofiltration	≥ 3.7	≥ 4.1	ND [§]	ND [§]	≥ 1.8	ND [§]	0.5

Process Step	Enveloped Virus				Non-Enveloped Virus		
	HIV-1	BVDV	PRV	WNV	Reo3	HAV	PPV
Low pH Final Container Incubation	≥5.3	4.9	≥5.1	≥5.3	NA [‡]	NA [‡]	NA [‡]
Overall Clearance Capacity	≥16.5	≥20.2	≥13.0	≥10.4	≥9.3	≥5.0	8.2

* C/I: Interference by caprylate precluded determination of virus clearance capacity for this step.

† DHBV and SINV were also evaluated for the caprylate incubation step. The log₁₀ clearance capacities were ≥3.6 and ≥6.0, respectively.

‡ NA = Not applicable: This step is not applicable to non-enveloped viruses.

§ Due to interfering effects of the process intermediate matrix the virus clearance capacity could not be determined.

Additionally, the manufacturing process was investigated for its capacity to decrease the infectivity of an experimental agent of transmissible spongiform encephalopathy (TSE), considered as a model for the variant Creutzfeldt-Jakob disease (vCJD), and Creutzfeldt-Jakob disease (CJD) agents.

Several of the individual production steps of the manufacturing process have been shown to decrease TSE infectivity of an experimental model agent. TSE reduction steps include depth filtrations (a total of ≥ 6.6 log₁₀). These studies provide reasonable assurance that low levels of vCJD/CJD agent infectivity, if present in the starting material, would be removed.

12 CLINICAL PHARMACOLOGY

12.1 Mechanism of Action

XEMBIFY supplies a broad spectrum of opsonizing and neutralizing immunoglobulin G (IgG) antibodies against bacterial, viral, parasitic, and mycoplasmal agents and their toxins. XEMBIFY also contains a spectrum of antibodies capable of interacting with and altering the activity of cells of the immune system. The role of these antibodies and the mechanism of action of XEMBIFY are not fully understood.

12.2 Pharmacodynamics

Human normal immunoglobulin contains mainly (IgG) with a broad spectrum of antibodies against infectious agents. Human normal immunoglobulin contains the IgG antibodies present in the normal population. XEMBIFY has a distribution of IgG subclasses closely proportional to that in native human plasma. Adequate doses of XEMBIFY may restore abnormally low IgG levels to the normal range.

12.3 Pharmacokinetics

Pharmacokinetic (PK) parameters of subcutaneously administered XEMBIFY were evaluated in patients with primary immunodeficiency (PI) during a clinical trial in North America. [see *Clinical Studies (14)*] Patients were treated intravenously with a comparator product [GAMUNEX[®]-C, immune globulin injection (human), 10% caprylate/chromatography purified] during a 3-4 months run-in period prior to IV PK profiling in 50 patients, and then

49 patients switched to weekly subcutaneous infusions of XEMBIFY for 24 weeks at 137% of the intravenous dose with PK profiling at SC Week #13-14. A comparison of the area under the curve (AUC) for subcutaneous versus intravenous infusion was performed.

At the 137% dose adjustment, the geometric least-squares means ratio of the AUC for subcutaneous XEMBIFY versus IV administration of GAMUNEX-C was 104% (90% CI: 100%-107%). The peak IgG level occurred at a mean of 76 hours after subcutaneous XEMBIFY administration. The average mean IgG trough level at steady state was higher with XEMBIFY (1245 mg/dL) compared with IV GAMUNEX-C (957 mg/dL) (average mean trough ratio SC/IV of 1.3). PK parameters of XEMBIFY compared to IV GAMUNEX-C are summarized in Table 6. PK parameters did not significantly differ between age groups (Table 7).

Table 6: PK Parameters of Total IgG at Steady-State in IV and SC Phases (PK Population) in Children and Adults

Phase	Statistics	AUC _(0-7 days) (h*mg/dL)*	C _{max} (mg/dL)	t _{max} (hour)
IV	N	49	49	49
	Mean±SD	212151±41832	2154±437	5.8±8.0
	CV%	20	20	137.9
	Min, Max	106091, 308405	1430, 3170	0.8, 48.9
SC	N	39	41	41
	Mean±SD	218316±48121	1395±312	76.1±35.7
	CV%	22	22	46.9
	Min, Max	102650, 367496	636, 2320	0.0, 167.7†

* AUC_(0-7 days) in the IV Phase is calculated as AUC_(0-21 days)/3 for patients on an every-3-week IV dosing schedule (n=6), and as AUC_(0-28 days)/4 for patients on an every-4-week IV dosing schedule (n=43).

† The apparent variability in t_{max} in the SC Phase can be attributed to the low fluctuation in IgG concentrations and is unlikely to be of any clinical relevance.

Table 7: Steady-State PK Parameters for XEMBIFY by Age

Age Group (years)	Statistics	AUC _(0-7 days) (h*mg/dL)	C _{max} (mg/dL)	Mean Trough (mg/dL)	t _{max} (hour)
2 -5 (n)	1	1	1	1	1
Mean±SD	183864±NC*	1130±NC*	1078±NC*	72±NC*	
>5 -12 (n)	5	5	6	5	
Mean±SD	215558±27604	1372±183	1194±183	71±26	
CV%	13	13	15	37	
Min, Max	187838, 245614	1200, 1580	993, 1510	28, 101	
>12 -16 (n)	4	5	5	5	
Mean±SD	240009±40578	1548±281	1379±209	73±50	
CV%	17	18	15	68	
Min, Max	205646, 298678	1290, 2000	1095, 1665	24, 143	
>16 (n)	29	30	32	30	
Mean±SD	216987±52389	1383±335	1239±296	78±36	
CV%	24	24	24	47	

Age Group (years)	AUC _(0-7 days) (h*mg/dL)	C _{max} (mg/dL)	Mean Trough (mg/dL)	t _{max} (hour)
Statistics				
Min, Max	102650, 367496	636, 2320	652, 2048	0, 168

* NC = Not calculated

A study evaluating serial PK parameters between weekly and biweekly (every 2 weeks) dosing regimens for treatment-experienced adults with PI included 25 evaluable patients, including 23 who were evaluable for both dosing regimens. The geometric least-squares means ratio of the AUC_(0-7 days) for XEMBIFY administration biweekly compared to weekly is 104% (90% CI: 100%-107%). PK parameters at steady state comparing weekly to biweekly dosing of XEMBIFY are summarized in Table 8. For biweekly dosing, population PK modeling demonstrates simulated steady state C_{max}, C_{min}, and AUC_{tau} values of pediatric patients are within the 5th to 95th percentile of adult values.

Table 8: Steady State PK Parameters for XEMBIFY Weekly and Biweekly Dosing in Adult PK Population

Period	Statistics	AUC _(0-7 days) (h*mg/dL)*	C _{max} (mg/dL)	t _{max} (hour)
Weekly	n	23	25	25
	Mean±SD	170386 ± 35949	1076 ± 228	79 ± 40
Biweekly	n	23	23	23
	Mean±SD	174561 ± 36974	1151 ± 243	103 ± 44

* AUC_(0-7 days) in the biweekly period is calculated as AUC_(0-14 days)/2 for patients on an every 2-week dosing schedule.

A study in treatment-naïve adults with PI (n=6) evaluated the trough IgG levels following initiation of a XEMBIFY loading dose regimen (150 mg/kg/day for 5 consecutive days) and after weekly maintenance XEMBIFY dosing regimen (150 mg/kg/week for 32 weeks). Following the initial loading dose and prior to initiating maintenance dosing, five (83%) patients attained an IgG trough level >700 mg/dL at Week 1 (Day 8). Three (50%) patients required dose adjustments. All 6 patients attained IgG trough levels >700 mg/dL by Week 8 and were maintained through the end of the study at Week 32. During the weekly maintenance phase patients received 150 mg/kg/week - 180 mg/kg/week of XEMBIFY and had mean trough IgG levels of at least 901 mg/dL at all timepoints from Week 8 through the end of study Week 32. Simulated population PK analysis (including data from previously treated pediatric and adult patients with PI) showed similar IgG exposure to treatment naïve patients following a loading dose and maintenance dose regimen of XEMBIFY. The IgG exposure following a loading dose plus maintenance dose regimen is expected to be similar between treatment-naïve pediatric and adult patients.

13 NONCLINICAL TOXICOLOGY

13.1 Carcinogenesis, Mutagenesis, Impairment of Fertility

No nonclinical studies were conducted to evaluate the carcinogenic or mutagenic effects of XEMBIFY or its effects on fertility.

13.2 Animal Toxicology and/or Pharmacology

Single and repeated dose toxicology studies were conducted in male New Zealand White rabbits. In a single-dose toxicity study, no adverse effects were observed with subcutaneous dose levels of 500, 1000 and 1500 mg/kg. In a repeated-dose toxicity study, the systemic safety and toxicity profiles of XEMBIFY and comparator GAMUNEX-C were similar following 5 consecutive daily subcutaneous doses at levels of 500, 1000 and 1500 mg/kg/day. Transient local injection site swelling was observed in XEMBIFY but not in the GAMUNEX-C groups.

In improper delivery route studies, XEMBIFY administered as a single intravenous, intra-arterial or perivascular dose of 100 mg/kg caused injection site irritation in New Zealand White rabbits. The findings were of higher incidence following perivascular administration of either XEMBIFY or GAMUNEX-C and were within the norms of this route of administration in this species.

14 CLINICAL STUDIES

Study 1

Study 1 was a prospective, open-label single-arm, multi-center clinical trial designed to evaluate safety, efficacy, and pharmacokinetics of XEMBIFY in patients with PI conducted in North America. Safety and pharmacokinetics were assessed as compared to GAMUNEX-C. The GAMUNEX-C run-in phase prior to XEMBIFY (subcutaneous phase) lasted 3 or 4 months to achieve steady state prior to pharmacokinetic profiling. Efficacy was based on annualized serious bacterial infection (SBI) rate during the 6 months on XEMBIFY. The following were considered SBIs: bacteremia/sepsis, bacterial meningitis, bacterial pneumonia, osteomyelitis/septic arthritis, or visceral abscess.

A total of 53 adult and pediatric patients with PI enrolled (9% Hispanic or Latino; 91% White, 4% Black or African American, 6% American Indian or Alaskan Native). During the run-in and IV GAMUNEX-C phases, 4 patients discontinued. XEMBIFY was administered to a total of 49 patients (including 14 children aged 2 to \leq 16 years and 35 adults) with a mean \pm SD dose of 179 ± 45 mg/kg/week for a median treatment duration of 24 weeks and mean \pm SD of 22 ± 7 weeks. The median dose was 171 mg/kg/week and the range of doses was 71 mg/kg/week to 276 mg/kg/week. The total exposure of XEMBIFY was 20 patient-years and 1053 infusions.

The rate of SBIs was 0.05 events per patient-year (1 event in 20 patient-years) (upper 99% confidence limit: 0.11) during XEMBIFY treatment. This annual rate was lower than 1.0 SBI/patient-year, the threshold specified as effective.

The summary of infections and associated events for patients during subcutaneous treatment with XEMBIFY in Study 1 is summarized in [Table 9](#).

Table 9: Summary of Infections and Associated Events on XEMBIFY in Study 1

Parameters	Results
Number of patients (efficacy period)	49
Total number of patient days on treatment	7,407
Total number of patient-years on treatment	20.28
Infections	
Annual rate of SBIs* (per patient-year)	0.05 (95% CI: 0.02 - 0.10)
Annual rate of infections of any kind (per patient-year)	2.4 (95% CI: 1.6 - 3.3)
Days on antibiotics (prophylactic) (rate per patient-year)	27.7 (95% CI: 13.6 - 49.0)
Days on antibiotics (therapeutic) (rate per patient-year)	28.9 (95% CI: 17.3 - 44.8)
Days missed work/school/unable to perform normal daily activities due to infections (rate per patient-year)	2.3 (95% CI: 1.1 - 4.2)
Hospitalizations due to infections (rate per patient-year)	0.05 (95% CI: 0.02 - 0.10)

* Serious bacterial infections included bacteremia/sepsis, bacterial meningitis, bacterial pneumonia, osteomyelitis/septic arthritis, or visceral abscess.

Study 2

Study 2 was a prospective, open-label, single-arm, multi-center clinical trial designed to evaluate efficacy and safety of XEMBIFY conducted in the European Union and Australia in patients with PI. Efficacy was based on annualized SBI rate during 12 months on XEMBIFY using a 1:1 dose adjustment factor with the patient's previous subcutaneous or IV IgG replacement regimen and a minimum XEMBIFY dose of 100 mg/kg/week. If the XEMBIFY infusion was well tolerated during 2 infusions with an initial target rate of less than or equal to 25 mL/hour/site, the infusion rate could be increased in a stepwise manner at the investigator's discretion up to a maximum of 60 mL/hr/site, and if well tolerated, subsequent infusions could begin at that rate; the investigator could also decrease the infusion rate at any time based on the patient's tolerability. The definition of SBI was the same as for Study 1.

Study 2 enrolled 61 patients with PI, including 32 adults and 29 children aged 2 to ≤ 16 years. The majority (93%) were White, and 16% were Hispanic or Latino. During the study, 6 patients discontinued (including 4 due to adverse events). XEMBIFY was administered with

a median dose of 113 mg/kg/week ranging 67 to 212 mg/kg/week. The median treatment duration was 52 weeks.

There was one SBI in a 10 year old patient for an annualized SBI rate of 0.017 events per patient-year (upper 99% confidence limit: 0.036) during XEMBIFY treatment. There were a total of 14 patients who were administered XEMBIFY SC infusions at rates greater than 25 mL/hr/site. Seven patients (6 male; 1 female) received at least 3 consecutive XEMBIFY SC infusions at rates of ≥ 35 mL/hr/site (4 children [ages 10-15 years] and 3 adults) and maximum infusion rates ranged from 38 mL/hr/site to 80 mL/hr/site. One patient discontinued from the study early while at a sustained infusion rate of 50 mL/hr/site due to an adverse reaction of subcutaneous fibroma (mild) that was initially reported while the patient was receiving XEMBIFY at a rate of 15 mL/hr/site. One patient (maximum infusion rate 38 mL/hr/site) experienced an adverse reaction of infusion site necrosis (mild) that resulted in a decrease in XEMBIFY infusion rate to 25 mL/hr/site. All infusion site reactions at higher infusion rates were considered mild in severity.

Study 3

Study 3 was an open-label, multicenter, Phase 4 study conducted in the United States, which included two study arms. The treatment-experienced arm consisted of a single-sequence crossover of weekly-to-biweekly XEMBIFY dosing designed to evaluate the pharmacokinetic non-inferiority and safety of XEMBIFY administered every 2 weeks in treatment-experienced patients with PI. The treatment-naïve arm consisted of a loading regimen followed by weekly maintenance infusions of XEMBIFY to evaluate pharmacokinetics and safety for treatment-naïve patients initiating IgG replacement therapy for the first time.

Patients in the treatment-experienced arm received weekly XEMBIFY dosing initially and transitioned to biweekly dosing at Week 16 through Week 32. A dose adjustment factor of 1.37 was employed for patients entering this study on commercial IVIG. Patients in the treatment-naïve arm initiated IgG replacement therapy for the first time with XEMBIFY (5-day loading regimen 150 mg/kg/day followed by weekly 150 mg/kg/week); dose adjustment in the maintenance phase was allowed to achieve a target IgG trough of 700 mg/dL. Pharmacokinetic assessments were to assess XEMBIFY exposure for both treatment-experienced and treatment-naïve patients.

Thirty-three adults with PI were treated with XEMBIFY in Study 3, including 27 treatment-experienced patients and 6 treatment-naïve patients, all of whom were White and non-Hispanic/Latino. During the study 4 patients discontinued, including 3 treatment-experienced patients (2 for adverse events), and 1 treatment-naïve patient. Two treatment-experienced patients discontinued during the weekly phase and did not receive biweekly XEMBIFY.

For treatment-experienced patients during the weekly dosing period, the median XEMBIFY dose was 138 mg/kg/week ranging from 99 to 247 mg/kg/week, with a median treatment duration of 16 weeks. During the biweekly (every 2 weeks) dosing period, the median dose was 273 mg/kg/2 weeks ranging from 134 to 494 mg/kg/2 weeks, with a median treatment duration of 18 weeks.

For treatment-naïve patients the median XEMBIFY dose was 153 mg/kg per infusion ranging from 150 to 180 mg/kg per infusion with a median treatment duration of 32 weeks.

XEMBIFY exposure was similar between weekly and biweekly dosing in the treatment-experienced patients [see *Clinical Pharmacology (12.3)*].

Target IgG trough levels were achieved following the loading dose and maintenance dose regimen in treatment-naïve patients [see *Clinical Pharmacology (12.3)*].

15 REFERENCES

1. Buckley RH, Schiff RI. The use of intravenous immune globulin in immunodeficiency diseases. *N Engl J Med* 1991;325(2):110-7.
2. Cunningham-Rundles C, Bodian C. Common variable immunodeficiency: clinical and immunological features of 248 patients. *Clin Immunol* 1999;92(1):34-48.
3. Pruzanski W, Sussman G, Dorian W, et al. Relationship of the dose of intravenous gammaglobulin to the prevention of infections in adults with common variable immunodeficiency. *Inflammation* 1996;20(4):353-9.
4. Stephan JL, Vlekova V, Le Deist F, et al. Severe combined immunodeficiency: a retrospective single-center study of clinical presentation and outcome in 117 patients. *J Pediatr* 1993;123(4):564-72.
5. Dalakas MC. High-dose intravenous immunoglobulin and serum viscosity: risk of precipitating thromboembolic events. *Neurology* 1994;44:223-6.
6. Woodruff RK, Grigg AP, Firkin FC, et al. Fatal thrombotic events during treatment of autoimmune thrombocytopenia with intravenous immunoglobulin in elderly patients. *Lancet* 1986;2:217-8.
7. Wolberg AS, Kon RH, Monroe DM, et al. Coagulation factor XI is a contaminant in intravenous immunoglobulin preparations. *Am J Hematol* 2000;65:30-4.
8. Cayco AV, Perazella MA, Hayslett JP. Renal insufficiency after intravenous immune globulin therapy: a report of two cases and an analysis of the literature. *J Am Soc Nephrol* 1997;8(11):1788-94.
9. Pierce LR, Jain N. Risks associated with the use of intravenous immunoglobulin. *Trans Med Rev* 2003;17:241-51.
10. Copelan EA, Strohm PL, Kennedy MS, et al. Hemolysis following intravenous immune globulin therapy. *Transfusion* 1986;26:410-2.
11. Thomas MJ, Misbah SA, Chapel HM, et al. Hemolysis after high-dose intravenous Ig. *Blood* 1993;15:3789.

12. Wilson JR, Bhoopalam N, Fisher M. Hemolytic anemia associated with intravenous immunoglobulin. *Muscle & Nerve* 1997;20:1142-5.
13. Kessary-Shoham H, Levy Y, Shoenfeld Y, et al. In vivo administration of intravenous immunoglobulin (IVIg) can lead to enhanced erythrocyte sequestration. *J Autoimmun* 1999;13:129-35.
14. Kahwaji J, Barker E, Pepkowitz S, et al. Acute hemolysis after high-dose intravenous immunoglobulin therapy in highly HLA sensitized patients. *Clin J Am Soc Nephrol* 2009;4:1993-7.
15. Daw Z, Padmore R, Neurath D, et al. Hemolytic transfusion reactions after administration of intravenous immune (gamma) globulin: A case series analysis. *Transfusion* 2008;48:1598-601.
16. Rizk A, Gorson KC, Kenney L, et al. Transfusion-related acute lung injury after the infusion of IVIG. *Transfusion* 2001;41:264-8.

16 HOW SUPPLIED/STORAGE AND HANDLING

XEMBIFY is supplied in 1, 2, 4, and 10 grams of protein single use vials.

Package NDC Number	Container NDC Number	Size	Grams of Protein
13533-810-05	13533-810-06	5 mL	1
13533-810-10	13533-810-11	10 mL	2
13533-810-20	13533-810-21	20 mL	4
13533-810-50	13533-810-51	50 mL	10

Components used in the packaging are not made with natural rubber latex and contain no preservative.

Store XEMBIFY at 2–8°C (36–46°F).

Note: XEMBIFY may be stored at temperatures not to exceed 25°C (77°F) for up to 6 months any time prior to the expiration date. Following 25°C (77°F) storage, use the product immediately or discard.

Do not freeze.

Do not use solutions that have been frozen.

Do not use after expiration date.

Discard unused portion.

17 PATIENT COUNSELING INFORMATION

Advise the patient to read the FDA-approved patient labeling ((Patient Information and Instructions for Use).

Ask about a history of IgA deficiency, and hypersensitivity reactions to immune globulin treatment. [see *Warnings and Precautions (5.3)*]

Inform patients to immediately report the following signs and symptoms to their healthcare provider: [see *Boxed Warning and Warnings and Precautions*]

Severe headache, neck stiffness, drowsiness, dizziness, fever, sensitivity to light, painful eye movements, nausea, and vomiting [see *Warnings and Precautions (5.1), Adverse Reactions (6.2)*]

Symptoms of thrombosis which may include: pain and/or swelling of an arm or leg with warmth over the affected area, discoloration of an arm or leg, unexplained shortness of breath, chest pain or discomfort that worsens on deep breathing, unexplained rapid pulse, numbness or weakness on one side of the body [see *Warnings and Precautions (5.2)*]

Hypersensitivity reaction including hives, generalized urticaria, itching, rash, tightness of the chest, wheezing, low blood pressure, and anaphylaxis [see *Warnings and Precautions (5.3), Adverse Reactions (6.2)*]

Decreased urine output, sudden weight gain, fluid retention/edema, and/or shortness of breath [see *Warnings and Precautions (5.4)*]

Increased heart rate, fatigue, yellowing of the skin or eyes, and dark-colored urine [see *Warnings and Precautions (5.5)*]

Trouble breathing, chest pain, pain, blue lips or extremities, chills, and fever [see *Warnings and Precautions (5.6)*]

Injection site reactions such as induration and warmth [see *Adverse Reactions (6.2)*]

Inform patients/caregivers that because XEMBIFY is made from human blood, it may carry a risk of transmitting infectious agents, e.g., viruses, the variant Creutzfeldt-Jakob disease (vCJD) agent and, theoretically, the Creutzfeldt-Jakob disease (CJD) agent. [see *Warnings and Precautions (5.7)*]

Inform patients that XEMBIFY can interfere with their immune response to live virus vaccines such as measles, mumps, rubella, and varicella. Inform patients to notify their healthcare provider of this potential interaction when they are receiving vaccinations. [see *Drug Interactions (7.2)*]

Self-administration

Advise the patient to read the FDA-approved patient labeling (Patient Information and Instructions for Use).

If self-administration is deemed appropriate by the healthcare provider, provide clear instructions and training on subcutaneous infusion to the patient/caregiver, and document demonstration of their ability to independently administer subcutaneous infusions.

Ensure the patient/caregiver understands the importance of consistent subcutaneous infusions to maintain appropriate steady IgG levels.

Tell the patient/caregiver to start the infusion promptly after withdrawing XEMBIFY into the syringe. Ensure the patient/caregiver understands that administration should be completed within 2 hours to avoid the potential formation of particles caused by siliconized syringes.

Instruct patient to rotate infusion sites for subsequent infusions.

Instruct the patient/caregiver to keep a treatment diary/log book. This diary/log book should include information about each infusion such as, the time, date, dose, lot number(s), infusion sites, and any reactions.

Inform the patient that mild to moderate local infusion site reactions (e.g., pain, redness and itching) are a common side effect of subcutaneous treatment, but to contact their healthcare provider if a local reaction increases in severity or persists for more than a few days.

Instruct patient to return to the healthcare facility for evaluation at regular intervals so IgG levels can be checked in order to ensure IgG trough levels are adequate.

Manufactured by:

GRIFOLS

Grifols Therapeutics LLC

Research Triangle Park, NC 27709 USA

U.S. License No. 1871

INFORMATION FOR PATIENTS

XEMBIFY®

(immune globulin subcutaneous, human-klhw) 20% solution

The following summarizes important information about XEMBIFY (zem-ba-fi). Please read this information carefully before using this medicine. This patient information does not take the place of talking with your healthcare provider about your medical condition or your treatment, and it does not include all of the important information about XEMBIFY. If you have any questions after reading this, contact your healthcare provider.

What is XEMBIFY?

XEMBIFY is a ready-to-use, liquid medicine that contains immunoglobulin G (IgG) antibodies, which protect the body against infection. XEMBIFY is used to treat patients with primary immunodeficiency disease (PI).

There are many forms of PI. The most common types of PI result in an inability to make a very important type of protein called antibodies, which help the body fight off infections from bacteria or viruses. XEMBIFY is made from human plasma that is donated by healthy people. It contains antibodies collected from these healthy people that replace the missing antibodies in PI patients.

Who should NOT use XEMBIFY?

Do not use XEMBIFY if you have a known history of severe allergic reaction to immune globulin (human) or other blood products. If you have such a history, discuss this with your healthcare provider to determine if XEMBIFY is right for you.

Tell your healthcare provider if you have or ever had:

- a serious reaction to other medicines that contain immune globulin.
- an immunoglobulin A (IgA) deficiency.
- a history of heart or blood vessel disease.
- blood clots or “thick blood”.
- inability to move for some time.

How should I take XEMBIFY?

XEMBIFY is given under the skin (subcutaneously). Most of the time, infusions under the skin are given at home by self-infusion or by infusion with a caregiver’s help. Self-infusion is different from giving yourself a shot.

Instructions for taking XEMBIFY are at the end of this patient information. [*see "Instructions for Use"*] Only use XEMBIFY by yourself after you have been instructed by your healthcare provider.

What should I tell my healthcare provider before using XEMBIFY?

Tell your healthcare provider if you have had a serious reaction to other medicines that contain immune globulin. Also tell your healthcare provider if you have an immunoglobulin A (IgA) deficiency.

XEMBIFY can make certain types of vaccines (like measles/mumps/rubella or chickenpox) not work as well for you. Before you get a vaccine, tell the healthcare provider that you are taking XEMBIFY.

Tell your healthcare provider if you are pregnant or plan to become pregnant, or if you are nursing.

What are possible or reasonably likely side effects of XEMBIFY?

The most common side effects with XEMBIFY are:

- Infusion site reactions, including but not limited to
 - infusion site erythema (redness)
 - infusion site pain
 - infusion site swelling (puffiness)
 - infusion site bruising
 - infusion site nodule
 - infusion site pruritus (itching)
 - infusion site induration (firmness)
 - infusion site scab
 - infusion site edema

- Cough
- Diarrhea

If any of the following problems occur after starting treatment with XEMBIFY, stop the infusion immediately and contact your healthcare provider or call emergency services. These could be signs of a serious problem.

Hives, swelling in the mouth or throat, itching, trouble breathing, wheezing, fainting or dizziness. These could be signs of a serious allergic reaction.

Severe headache with or without nausea, vomiting, stiff neck, fever, sensitivity to light, painful eye movements, or fatigue. These could be signs of irritation of the lining around your brain called aseptic meningitis.

Reduced urination, sudden weight gain, or swelling in your legs. These could be signs of a kidney problem.

Pain, swelling, warmth, redness, or a lump in your legs or arms. These could be signs of a blood clot.

Brown or red urine, fast heart rate, yellow skin or eyes. These could be signs of a liver problem or a blood problem.

Chest pain or trouble breathing, or blue lips or extremities. These could be signs of a serious heart or lung problem.

Fever over 100°F (37.8°C). This could be a sign of an infection.

Tell your healthcare provider about any side effects that concern you. You can ask your healthcare provider to give you the full prescribing information available to healthcare providers. You are encouraged to report side effects to Grifols Therapeutics LLC [1-800-520-2807].

How do I store XEMBIFY?

XEMBIFY comes in single use vials.

- Keep XEMBIFY refrigerated. Do not freeze.
- If needed, you can store XEMBIFY at room temperature for up to 6 months, but you must use it within that time or you must throw it away.
- Do not return XEMBIFY to the refrigerator if it was warmed to room temperature.
- Check the expiration date on the carton and vial label.
- Do not use XEMBIFY after the expiration date.

What else should I know about XEMBIFY?

Do not use XEMBIFY for a medical condition for which it was not prescribed. Do not share XEMBIFY with other people, even if they have the same diagnosis and symptoms that you have.

INSTRUCTIONS FOR USE

Infuse XEMBIFY only after you have been trained by your healthcare provider. Below are step-by-step instructions to help you remember how to use XEMBIFY. Ask your healthcare provider about any instructions you do not understand.

Before Using XEMBIFY

Prior to use, allow the solution to come to room temperature (68-77°F or 20-25°C). This can take 60 minutes or longer.

Do not apply heat or place in the microwave.

Step 1: Assemble supplies

Gather the XEMBIFY vial(s), ancillary supplies, sharps container, patient's treatment diary/logbook, and the infusion pump.

Step 2: Clean surface

Set up your infusion area on a clean, flat, non-porous surface, such as a kitchen counter.

Avoid using porous surfaces such as wood. Clean the surface with an alcohol wipe using a circular motion from the center outward.

Step 3: Wash hands

Wash and dry your hands thoroughly before using XEMBIFY.

Your healthcare provider may recommend that you use antibacterial soap or that you wear gloves.



Step 4: Check vials

The liquid in the vial should be clear to slightly opalescent, and colorless or pale yellow.

Do not use the vial if:

- the solution is cloudy or discolored. The solution should be clear to slightly opalescent, and colorless or pale yellow.

- the protective cap is missing, or there is any evidence of tampering. Tell your healthcare provider immediately.
- the expiration date has passed.

Step 5: Remove the protective cap

Remove the protective cap from the vial to expose the middle of the stopper.

Wipe the stopper with alcohol and allow to dry.

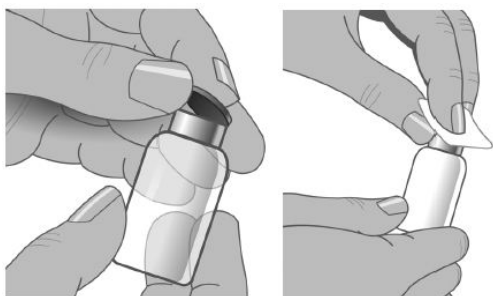

Step 6: Transfer XEMBIFY from vial(s) to syringe

Do not allow your fingers or other objects to touch the inner stem of the plunger, the syringe tip, or other areas that can touch the XEMBIFY solution. Make sure needles are capped until used and that needles and syringes stay on the clean area created in Step 2. This is called “aseptic technique” to prevent germs from getting into the XEMBIFY.

Using aseptic technique, attach each needle to the syringe tip.

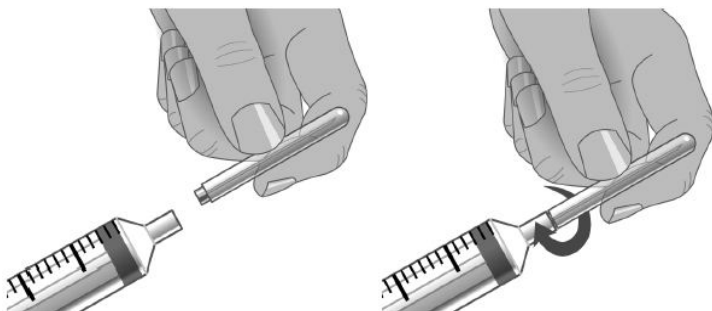

Step 7: Prepare the syringe and draw XEMBIFY solution into syringe

Remove cap from needle.

Pull the syringe plunger back to the level matching the amount of XEMBIFY to be withdrawn from the vial.

Place the XEMBIFY vial on a clean flat surface and insert the needle into the center of the vial stopper.

Inject air into the vial. The amount of air should match the amount of XEMBIFY to be withdrawn.

Turn the vial upside down and withdraw the correct amount of XEMBIFY. If multiple vials are required to get the correct dose, repeat Steps 4 - 7.

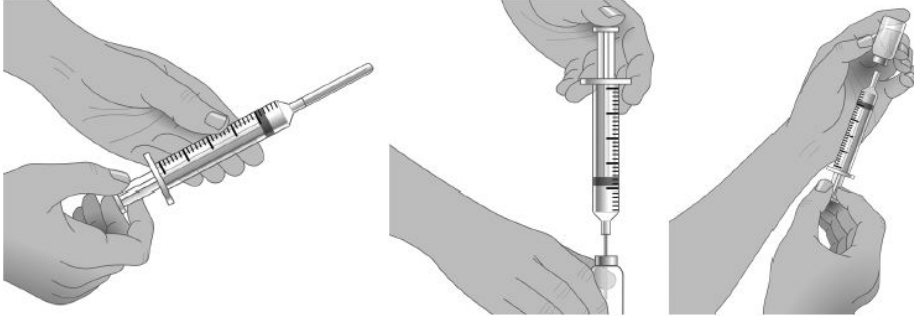

Step 8: Fill the pump reservoir and prepare the infusion pump

Follow the pump manufacturer's instructions for filling the pump reservoir and preparing the infusion pump, administration tubing and Y-site connection tubing, if needed.

Prime the administration tubing with XEMBIFY to take out any air left in the tubing or needle. To prime, hold the syringe in one hand and the administration tubing's capped needle in the other. Gently squeeze on the plunger until you see a drop of XEMBIFY come out of the needle.

Step 9: Select the number and location of infusion sites

Select one or more infusion sites as directed by your healthcare provider.

The number and location of injection sites depends on the volume of the total dose.

Avoid: bony areas, visible blood vessels, scars, and any areas of inflammation (irritation) or infection.

Rotate sites between future infusions.

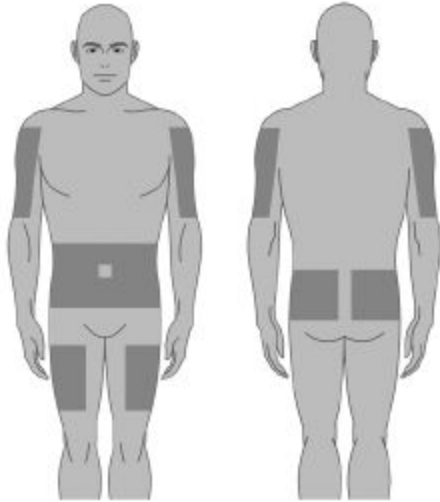

Step 10: Prepare the infusion site

Wipe the infusion site(s) with a sterile alcohol wipe beginning at the center of each infusion site and moving outward in circular motion. Allow the infusion site(s) to dry (at least 30 seconds).

Before infusion, sites should be clean, dry, and at least 2 inches (5 cm) apart.

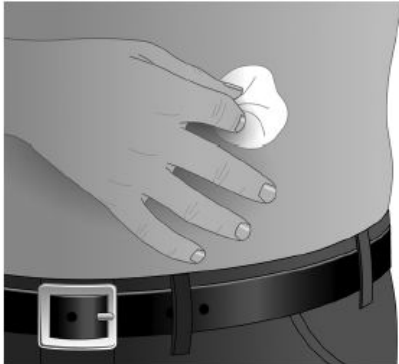

Step 11: Insert the needle

Grasp the skin between two fingers (pinch at least 1 inch (2.5 cm) of skin) and insert the needle at a 90-degree angle into the tissue underneath the skin or subcutaneous tissue.

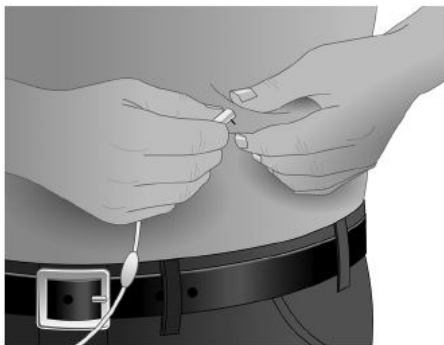

Step 12: Make sure the needle is not in a blood vessel

After inserting each needle into tissue (and before your infusion), make sure that a blood vessel has not been accidentally entered. To do this, attach a sterile syringe to the end of the primed administration tubing. Pull back on the syringe plunger and watch for any blood flowing back into administration tubing.

If you see any blood, remove and discard the needle and administration tubing.

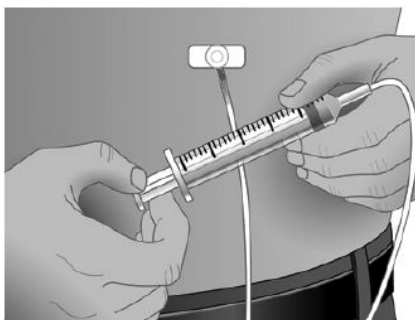

Repeat priming and needle insertion steps using a new needle, administration tubing and a new infusion site.

Secure the needle in place by applying sterile gauze or transparent dressing over the site.

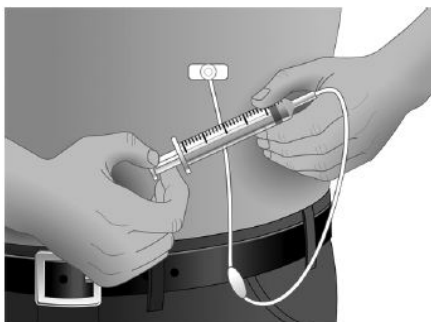

Step 13: Repeat for other sites, as needed

Step 14: Infuse XEMBIFY

Infuse XEMBIFY as soon as possible after it is prepared.

Follow the pump manufacturer's instructions for filling the tubing and using the infusion pump.

Step 15: After infusion

Follow manufacturer's instructions to turn off pump.

Undo and discard any dressing or tape.

Gently remove the inserted needle(s) or catheter(s).

Discard any unused solution in an appropriate waste container as instructed.

Discard any used administration equipment in an appropriate waste container.

Store your supplies in a safe place.

Follow manufacturer's instructions to care for the infusion pump.

Step 16: Record each infusion

Remove the peel-off label with the product lot number from the XEMBIFY vial and use this to complete the patient record. Include information about each infusion such as: the time, date, dose, lot number(s), infusion sites, and any reactions.

Remember to bring your journal with you when you visit your healthcare provider. Your healthcare provider may ask to see your treatment diary/logbook.

Tell your healthcare provider about any problems you have during your infusions. Call your healthcare provider for medical advice about side effects. You can also report side effects to FDA at 1-800-FDA-1088 or www.fda.gov/medwatch.

Manufactured by:

GRIFOLS

Grifols Therapeutics LLC

Research Triangle Park, NC 27709 USA

U.S. License No. 1871

Revised M/YYYY